



FLORIDA DEPARTMENT OF TRANSPORTATION - DISTRICT FOUR

BRIDGE PROJECT TO BEGIN FEB. 3, 2020

Seminole Drive Bridge Replacement Project
Over the L-16 Canal between Lantana Road and Tallulah Road in unincorporated Palm Beach County
Financial Project ID Number: 436894-4-52-01

Seminole Drive Bridge Replacement Project

Construction Cost: \$1,334,387

Construction Start: Feb. 3, 2020

Anticipated Completion: Early 2021

PROJECT IMPROVEMENTS

- Full bridge demolition and replacement
- Minor widening for bike lane and sidewalk installation

TRAFFIC IMPACTS

- The bridge will be closed completely for reconstruction as early as Monday, Feb. 10, 2020, through early 2021
- Motorists and pedestrians may detour via Lawrence Road and Tallulah Road as noted in the graphic below

CONTACT INFORMATION

Scott Passmore, P.E., FDOT Project Manager
scott.passmore@dot.state.fl.us or (561) 891-9321

Stephen Stokes, Project Administrator
sstokes@consoreng.com or (561) 723-6026

Meredith Cruz, Community Outreach Manager
mcruz@corrado.com or (561) 641-6440

Project website: www.d4fdot.com

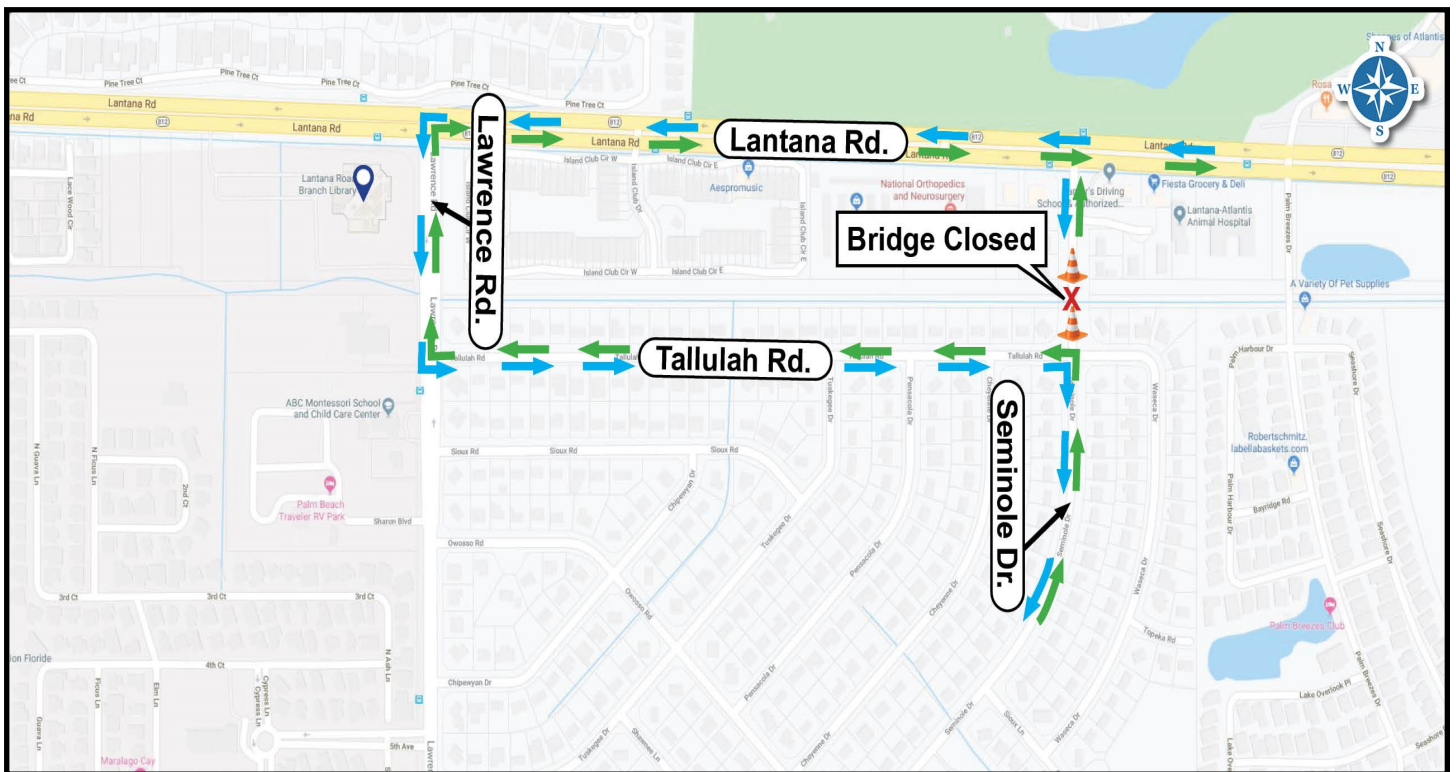

FLORIDA DEPARTMENT OF TRANSPORTATION MISSION STATEMENT

The Department will provide a safe transportation system that ensures the mobility of people and goods, enhances economic prosperity, and preserves the quality of our environment and communities.