



FLORIDA DEPARTMENT OF TRANSPORTATION - DISTRICT FOUR

Road Closure Begins March 15, 2020

State Road 15 Resurfacing Project

From south of Morgan Road to south of Shirley Drive in the City of Pahokee
Financial Project ID Number: 439843-1-52-01 & 439843-1-52-02

State Road 15 Resurfacing Project — Road Closure

Construction Cost: \$3,861,123

Construction Start: March 15, 2020

Anticipated Completion: Late 2020

TRAFFIC IMPACTS

- State Road 15, from Morgan Road to south of New Hope Charities, Inc., south of Shirley Drive, will be closed to traffic beginning Sunday, March 15, 2020 through late Spring 2020 for Phase 1 (of 2) for roadway resurfacing
- Only emergency vehicles will be able to pass through the construction zone during this time
- Motorists and pedestrians may detour via State Road 15, State Road 715, and Hooker Highway
- Hooker Highway to Morgan Road, and from New Hope Charities, Inc. north to Shirley Drive, will be open to local traffic only

PROJECT IMPROVEMENTS

- Roadway resurfacing from south of Morgan Road to south of Shirley Drive
- Guardrail replacement
- Installation of new signage and pavement markings

CONTACT INFORMATION

Jessica Lewis
FDOT Project Manager
Jessica.lewis@dot.state.fl.us
(561) 459-0908

Meredith Cruz
Community Outreach Specialist
mcruz@corradino.com
(561) 641-6440

Isel Munoz
Project Administrator
Isel.munoz@exp.com
(561) 657-5420

Project website:
www.d4fdot.com

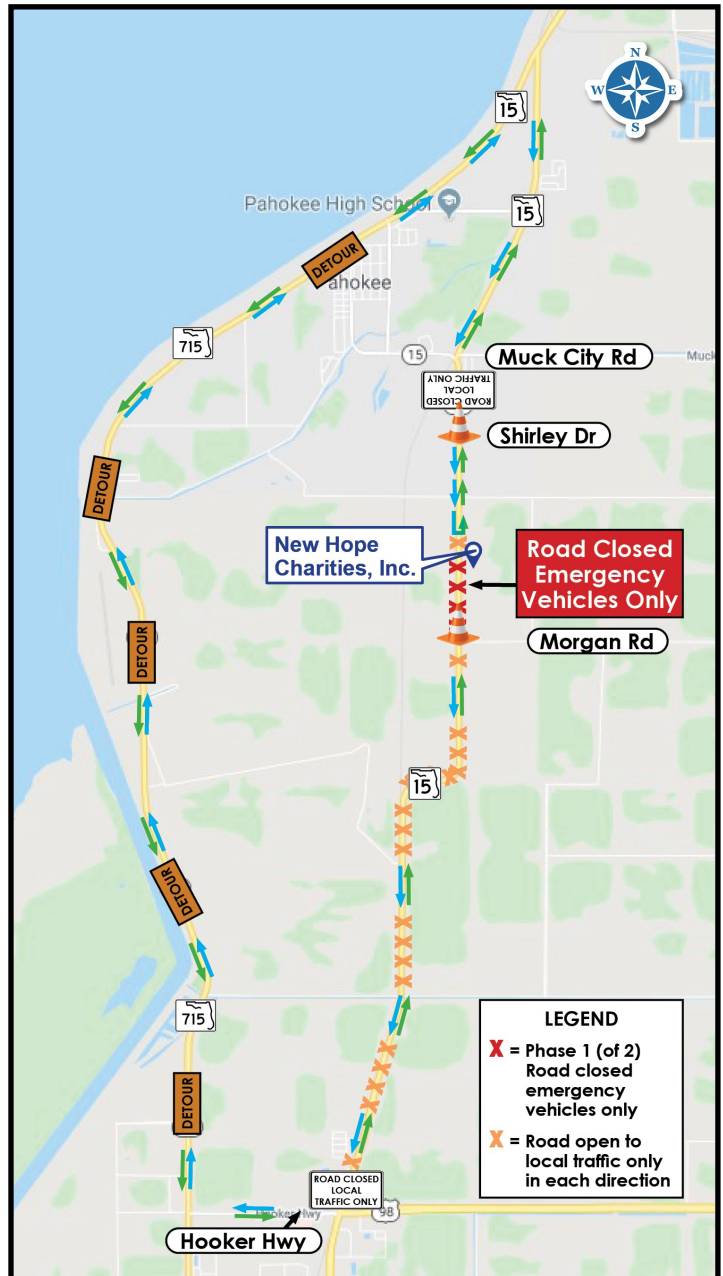

FLORIDA DEPARTMENT OF TRANSPORTATION MISSION STATEMENT

The Department will provide a safe transportation system that ensures the mobility of people and goods, enhances economic prosperity, and preserves the quality of our environment and communities.